

Reporter 80P WHERE SOLD

News and Views from around the area

Volume 12 Issue 1

January 2020

www.milbornestandrew.org.uk/reporter

facebook.com/MilborneReporter

Milborne St. Andrew

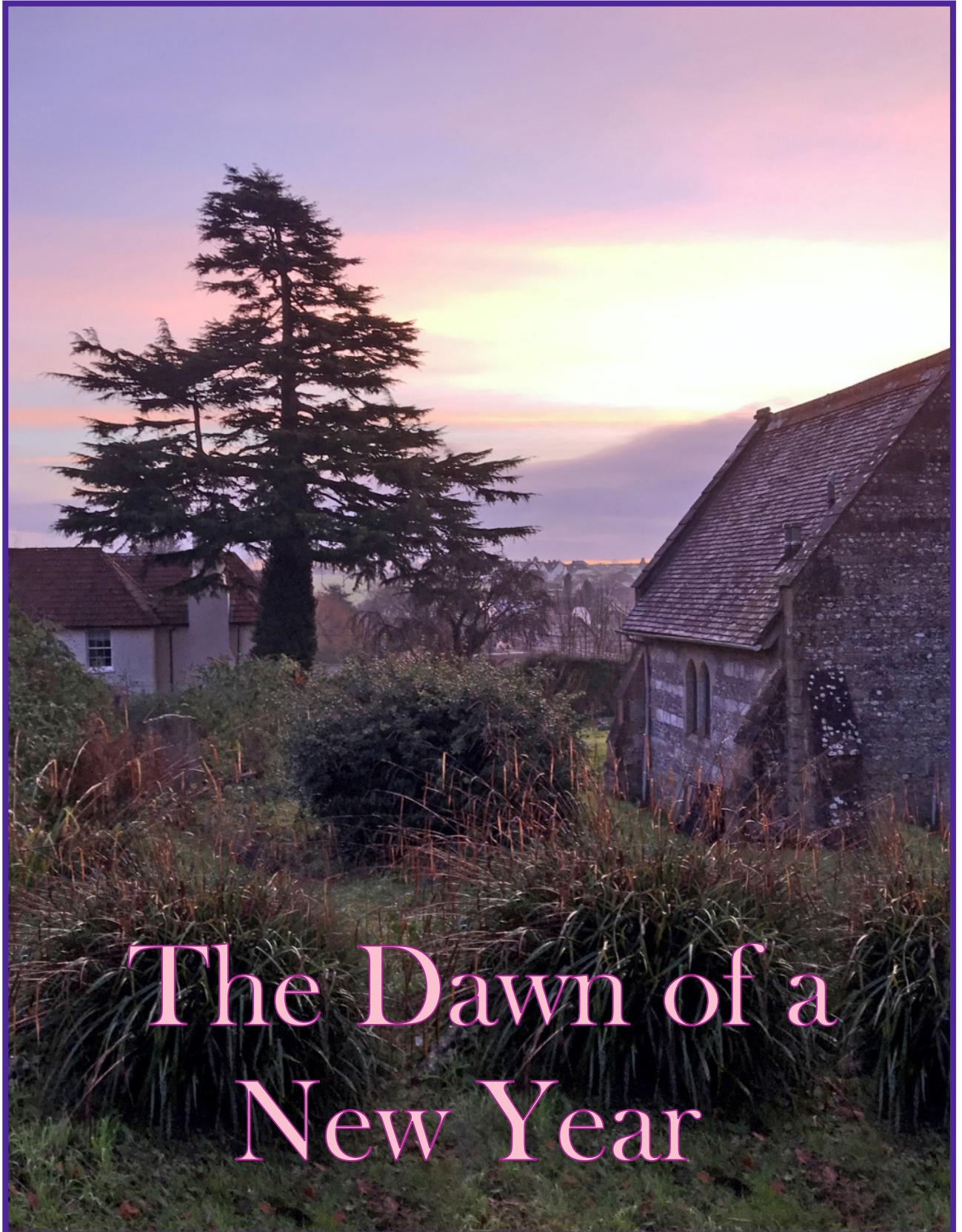

LOGON-WOODBURNERS LTD

SALES & INSTALLATIONS

20% DISCOUNT

ON STOVES FOR SUMMER INSTALLATIONS FROM
MAY TO SEPTEMBER...BEAT THE WINTER RUSH !!!



WOOD
AND MULTI FUEL
STOVES

CHIMNEY & ROOF
REPAIRS

FREE QUOTATIONS
& FULLY INSURED

FLEXIBLE FLUE
LINERS & RIGID
FLUE SYSTEMS

ALL BUILDING WORK
UNDERTAKEN

Checkatrade.com

WWW.LOGON-WOODBURNERS.COM

CALL STEVE GUSCOTT
M: 07733 477729 T: 01258 858537



LOGS

Quality Seasoned Hardwood Logs

Small Load £80 and Large Load £175

Kindling and Coal Household/Smokeless

20kg Household £10.50

20kg Smokeless £13.00



Tel/Fax: 01258 837377

Mobile: 07971 276980

VILLAGE LUNCH AGM

To be held at The Royal Oak on
Monday 13th January at 12.15pm
Everyone welcome

VILLAGE LUNCH

To be held at the Village Hall on
Saturday 25th January from 12.15 to 2.00pm

Wine (£1.00 per glass) or fruit juice

Lamb hotpot, carrot and swede mash

Sticky toffee pudding and custard

Mints and coffee or tea

Vegetarian option available

£7.00 per head

Prior booking essential by

Monday 20th January

Everyone welcome young and old alike

Tickets and more information available from
Josie Wright 839090 or Jenny Balcon 837121

Disclaimer

THE views expressed in the *Reporter* are not necessarily those of the editorial team. Also, please be aware that articles and photographs printed in the *Reporter* will be posted on our website and so are available for anyone to access.

The *Reporter* is not responsible for the content of any advertisement or material on websites advertised within this magazine.

Please note

Please ensure that your anti-virus software is up to date before e-mailing. Copy should be sent as a Word (or other) text file and do not embed pictures, logos, etc. into the document. Photos should be sent as separate .jpg files. Do not send articles as .pdf.

All these things may seem small to you but it does make all the difference in time saved later.

Advertise with the Milborne St. Andrew *Reporter*

Distributed to approximately 500 homes 11 times each year

Full page £210.00 p.a. / £42.00 per issue

Half page £147.00 p.a. / £26.00 per issue

Quarter page £78.50 p.a. / £13.50 per issue

Eighth page £52.50 p.a. / £7.50 per issue

Back page £375.00 per annum

Community events at the Milborne St. Andrew Village Hall, half page or less free of charge, other community events in Milborne St. Andrew at half the above rates for half page or less, all subject to availability.

Advertising copy MUST be received by the 14th of the month

msa.reporter@yahoo.co.uk

Your *Reporter* Team

Janet Allen, Linda Constant, Pete Constant,
Carole Fornachon, Heather V. Hogg, David Payne, Ed Richards,
Jo Whitfield, John and Josie Wright

Advertising: Ed Richards 01258 837907 (07843 018007)

Advertising renewals: Pete Constant 01258 839246 (daytime)

Distribution: Janet Allen 01258 837551

Editor: David Payne 01258 837700. Assistant Editor: Jo Whitfield

Treasurer and photography: Heather V. Hogg 01258 837392

Copy for the next issue MUST be received by mid-day 14th January

Enquiries and copy to: msa.reporter@yahoo.co.uk

E-copy as .docx or .pub files, pictures as .jpg files please.

Paper copy to any of the team



We are the Wednesday Social Club. As you can see from the photographs at our Christmas bash at the pub we are a friendly lot! The club meetings are held on the first Wednesday in the month from 2.00 to 4.00pm in the village hall and are open to anyone in the village for an annual fee of £15. Our meetings are varied; we sometimes have speakers or games afternoons and in the summer months we have trips and cream teas.

However, we always have plenty of time to chat over tea and biscuits and of course a raffle.

You don't have to come every time, it's very casual, just look in the *Reporter* or see our programme for coming events and if it appeals – come along. If you need a lift or want any more information please contact Sheila Burton on 01258 839033.



Fun at St. Andrew's Day
Fish Supper
See page 15

Heathcote House

GUEST
ACCOMMODATION
Tel: 01258 837219

Heathcote House is a lovely Grade II listed guest house right in the heart of Milborne St Andrew. We offer a warm welcome and friendly service, all rooms have king size beds, en-suite bathrooms and are tastefully refurbished to a very high standard.

- Aga cooked breakfast served in the conservatory under an old grape vine.
- Guests drawing room with big comfy sofas and log fires in the winter.
- A secluded garden with delightful seating areas.
- The perfect place from which to explore Dorset's unspoilt countryside and famous Jurassic coast a few miles away.



Heathcote House, Milborne St Andrew, Dorset DT11 0JG. Website: www.heathcotehouse.co.uk



Chris Perrins Chimney Sweep

Solid fuel stove installer



Flue relining
Fire place alterations
Chimney repairs
COWLS fitted

07824 698109

csweep.co.uk

cfperrins@tiscali.co.uk

P.N. GRAY ***ELECTRICAL LIMITED***

**AGRICULTURAL – DOMESTIC
INDUSTRIAL - COMMERCIAL INSTALLATIONS**
ESTABLISHED OVER 60 YEARS
VAT NO: 185-883-509

ALL ELECTRICAL WORK UNDERTAKEN FROM
INSTALLATIONS TO MINOR WORKS
INSPECTION AND TESTING
REWIRING AND MAINTENANCE

GIVE US A CALL FOR A FREE NO OBLIGATION
QUOTATION OR JUST SOME FRIENDLY ADVICE



Tel: 01258-837354

Mobile: 07774-838851

Email: pngrayelectrical@btinternet.com



live happy!
with
Slimming World

Now at
Puddletown First School, DT2 8FZ
On Monday evenings at 7.30pm
Call Julie 07871 821928 for more details

for this delicious curry recipe visit
slimmingworld.co.uk
0344 897 8000



*When people in the UK choose to attend a Slimming World group they must have any other weight loss group.

**Slimming
WORLD**
touching hearts, changing lives

Selling a car? Can't face the . . .



hassle?

We buy cars, bikes, campers and vans for cash at a time to suit you. Trading in elsewhere? We can usually offer more . . . Halcyon Motors, now based in Milborne St. Andrew, is a small, friendly business and we will happily come to you. Impartial advice comes free!

Buying? Visit www.halcyonmotors.co.uk to see "warts and all" descriptions and photos of our current stock. Warranties with all cars. Part exchange welcome. Call Don MacLeod 01258 839209 or 07782 189555 (Mon - Sun, 8.00am - 9.00pm)

Some Winter Tales from Darkest 19th Century Dorset

IN the November and December of 1830 Dorset experienced riots and uprisings by groups of farm labourers demanding higher wages and bent on destroying labour-saving threshing machines which threatened their livelihood. Dorset Militia guards stood at the doors of a boarded up Moreton House to protect the land owning Frampton family whose son, James, was to play a part in the arrest and conviction of six of those whose names are 'etched into trades' union history' as Roger Guttridge writes in December's Dorset Life. The Framptons had been Lords of the Manor of Moreton since, at least, the 14th century. James' sister Mary wrote an extensive diary at the time from which we know that, despite these strictures, Christmas festivities continued unabated. *'A peacock in full plumage was placed with a boar's head on the dinner table...a hare appear(ed) with a red herring astride on its back'*. Carol singers were ushered in and to all intents and purposes their Christmas *'passed with (the usual) large family party'*. When confronted whilst respectfully demanding an increase in their wages they would not disperse and the Riot Act was read. Frampton collared one man who came up to his horse but he escaped by slipping out of his smock-frock!

Country amusements were pursued in another part of Dorset around White Mill, an historic millhouse in Sturminster Marshall bequeathed to the National Trust in 1981 where the Joyce family ran the mill, farm and bakery since about 1550 until the early 1900's. The property ceased to be a water mill after the dam burst in 1865. H.S.Joyce (Harry) was born there in 1882 and wrote extensively about his childhood and fishing. The following anecdotes are from his book "A Country Childhood". A favourite winter occupation of the village men, Joyce writes, was 'Mumming'. They painted their faces, stuck feathers in their hats and tied ribbons to their clothes. *'One, at any rate, had a concertina; there was also a Doctor, a Turk and St George. They came into the kitchen, danced about in a grotesque fashion, did some sort of play in which (the aforementioned) had prominent parts, and received bread and cheese and some money'*. He mentions a magic lantern show

at childrens' parties projected onto a sheet stretched across the door. A particular slide which he remembers well showed a man asleep with his mouth open and down his mouth *'ran scores of mice'*. This was extremely popular and played again and again. Joyce believes it to have been *'one of those hated things...a story with a moral; the moral being don't sleep with your mouth open'*. An amusing tale is of the making of cherry brandy. The pulp having been thrown into the yard was eaten by the geese. Becoming intoxicated, they fell down and were perceived to be dead by their owners! So that they should not be a total loss they were plucked for the sake of their feathers. The chill of nakedness eventually roused them from their stupor and they were seen walking about the yard in this sad condition. The farmer's wife, taking pity on them and to offer some comfort, made them red flannel waistcoats! The sight of these birds going about in their red garments provided huge amusement and a retelling for years to come. It has now made the pages of the Milborne St. Andrew Reporter in 2019!

Carole Fornachon



Milborne Sports

a community space to be **PROUD** of

make a difference - VOLUNTEER - make things happen

BOOK this Space: Regular bookings £8.75hr (reduced start-up rates)
Kids Party: £25 **Adult Party:** £75 (incl set up and clear away times)
Wakes: **NO CHARGE** but we do accept a donation.
Wedding receptions / special events: special deals for local people/ groups

INTERESTED?
then please make contact
and tell us how you can help



THE BENEFICE OF PUDDLETOWN, TOLPUDDLE AND
MILBORNE WITH DEWLISH
PART OF THE CHURCH OF ENGLAND IN THE DIOCESE OF SALISBURY



Whose world is it anyway?

Martin Luther, the 16th-century Reformer, is alleged to have said: "If I knew the world would end tomorrow, I would still plant my apple tree."

There are different ways of interpreting this, but one possibility is to suggest that whatever the future holds, we should continue to do what we know is right.

By the time you read this, the General Election will seem a while ago, but as I write these thoughts it is still to come. Manifesto pledges often never make it into reality, but it is interesting to see what each political party is offering in terms of planting trees. Of the main parties, the highest promise would mean planting 170 trees per minute every minute until the end of 2040 (Labour); the lowest commitment 57 trees every minute until the end of 2024 (Conservative). Planting trees is a good thing for our creation, and deforestation over the years is one contributor to the climate change we are currently experiencing. However, on average one tree takes 100 years to absorb one tonne of carbon; a human being's activities give out ten tonnes a year. It's going to take an awful lot of trees to counteract that.

Most people believe that climate change is now a serious threat to the wellbeing of our world. Many say they want to do something about it. Extinction Rebellion has raised consciousness of climate-change activism. But protests and marches only go so far. Unless we all act in a way to preserve the wonders and beauties of God's creation, the damage will increase.

We say we want a better world, but how many of us are truly willing to make the sacrifices that will entail? How many people are willing to forego our foreign holidays? How many of us will walk a bit further in the rain when we can get into our cars and drive? How many of us count the airmiles in our food and endeavour to buy more local produce? How many of us enjoy buying new clothes when we have plenty of older ones that we can still wear? The biggest rise in the type of cars people are currently buying at present is in the gas-guzzling SUV category.

Most people are concerned about our world and its future, but for many that concern stops at the point it will mean a real change to our way of life. On the whole we have become very comfortable with our environmentally damaging lifestyles.

Christians and those of other faiths believe that God's hand is in Creation, and that we humans have a responsibility to care for our world and its amazing variety of life. Often it is those of no faith who speak loudest and act most gently towards our planet.

Salisbury diocese has formally recognised that there is a climate emergency. Our churches and their members need to take the calls to action more seriously, but ultimately it will require the willingness of us all to take the future of our world more seriously in our actions and words.

At the beginning of a new year, why not make a resolution to do whatever you can to help protect our world and its wonders?

Best wishes

Sarah

St Andrew's Church Notes

A new year and new beginning?

A Happy New Year greeting to you all from all in St. Andrew's Church and a big thank you to all who have supported our church in 2019, whether it's for flower arranging, cleaning, financial, prayers, reading, making coffee, etc.

I must be getting old as it doesn't seem like yesterday that we were worried about computers crashing after the clocks finished ringing out the old year of 1999. I find that at the end of a calendar year (not the church's year) I look back and think what I could have done and what I should not have done. I don't make New Year's resolutions as I am pretty sure that I would not keep them. However, I do try to take a fresh look at how our church and congregation reach out to others.

At St Andrew's we are lucky to have a 'stable' and committed group who support our church in many different ways but it would be good to attract new members. In theory I know how this should be done but in practice I find it hard. Why? I ask myself. Do I not pray hard enough, do I not persist in inviting people to the services and events? Do people see me coming and turn around so that I can't pester them? Or is it because I am not trusting in God enough?

Of course, I suppose there are many ways to tell people about our Lord and his love of us.

Services in the Benefice of Puddletown, Tolpuddle, Milborne and Dewlish January 2020

5th January – Epiphany

9.30am	Parish Communion	Tolpuddle
9.30	Celebrate	Milborne
11.00	Parish Communion	Puddletown
		Church Room
11.00	1662 Morning Prayer	Dewlish
4.00pm	Messy Church	Tolpuddle

12th January – Baptism of Christ

8.15am	1662 Said Communion	Puddletown
9.30	United Methodist Service	Topuddle
9.30	Parish Communion	Milborne
11.00	Puddletown Praise	Puddletown
		Church Room
11.00	Parish Communion	Dewlish

THURSDAY 16th January

12 noon	Lunch-time Communion	Puddletown
---------	----------------------	------------

19th January – Epiphany 2

9.30am	Family Communion	Tolpuddle
9.30	1662 Morning Prayer (said)	Milborne
11.00	Parish Communion	Puddletown
11.00	Family Service	Dewlish

26th January – Epiphany 3

9.30am	Go Fourth	Tolpuddle
9.30	Parish Communion	Milborne
11.00	1662 Morning Prayer	Puddletown
11.00	Family Communion	Dewlish

MORNING PRAYERS

Monday to Thursday 8.15 am Saturday. 9.00am

Monday – Puddletown	Tuesday – Milborne
Wednesday – Dewlish	Thursday – Tolpuddle
Saturday – Puddletown	

Church Contacts

Vicar Sarah Hillman 01305 848784
E-mail: sarah.c.hillman@outlook.com
Rev Rosie Coldwell 01258 839214

Churchwardens

Milborne St. Andrew

Pam Shults 01258 837203

Dewlish

Jim Burg 01258 837466

Sue Britton 01258 837218

Benefice Office

Emma Hughes
puddletownbenefice@outlook.com
or by telephone on 01305 849039

Do you need a lift to church?

If you have difficulty getting to church or need transport when the Benefice Service is at another church, we can arrange transport for you. Please contact Pam on 837203.

We are introducing more children to the 'Faith' through events such as Open the Book, Messy Church, Christingle, Milborne First School's services in our church and other activities. Many of these events include parents as well so hopefully we may be 'touching' them as well. Just because they don't come to church doesn't mean that they are not finding out more about the Bible and Christianity.

So, I will start this new year with optimism and trust in God to show me what I need to do, say, think and 'go forth'.

Pam Shults Churchwarden

Dewlish Church Notes

OUR Remembrance Day Service, led by Jim, was very well attended again, and we were thankful for a dry morning for once! Many thanks to John for putting up the posters in the centre of the village and for arranging for 16-year-old Harry Sawdy from Milborne St. Andrew to play the trumpet for us. We are most grateful to Harry too. A few of us went to the Village Hall for refreshments afterwards. It was good to see such a lot of people remembering those young men who gave their lives so that we may live freely.

Although at the time of writing this there are so many preparations to do for Christmas there will not be much going on in the church in January. That being so, *A Very Happy New Year* to you all!

Daphne Burg

Nature Note

DECEMBER often seems a bleak month with the leaves gone and the garden dormant, but if you were to take a walk as I did recently there is plenty to see and enjoy. The missing leaves allow a better view of birds in the trees and the evergreens to be seen at their best.

I recently took a walk around what we refer to as the 'two miler', up Coles Lane and left along the footpath and back to the village past the copse of trees planted by villagers in 1987 on what was known as the Parish Pit, or Taylors Pond.

A robin, maybe more than one, scolded me as I walked up the hill,

announcing its territory. In the fields at the top there were herring gulls and black headed gulls in their winter plumage of just a tiny dot of black on the side of its head. The winter migrants are now here in numbers with some two hundred redwings scattering from the fields and trees as I walked towards them. A few fieldfares are foraging in the fields appearing to be particularly large thrushes. I have been lucky enough to see a greater spotted woodpecker flitting in the branches of a tree. One of the attractive groups of birds commonly seen flitting through thin branches are long tailed tits. These are the only indigenous British bird that is exclusively insectivorous all year round and the reason they are seen in these thin branches is that they are searching for aphids hiding in the buds.

Occasionally there is a buzzard sitting on the top of a telegraph pole or on the nearly dead oak tree just up Dorchester Hill outside the village. I have seen a Red Kite on three occasions within the parish as they are moving from more northerly Dorset villages towards us and I am hoping to see them more often as time passes.

The few remaining leaves still have the bright yellows and oranges of autumn which earlier were such a dazzling vision. The loss of the leaves has made many of the remaining bushes appear more and more red as the profusion of the years berries become more obvious. The hawthorn, the hips on the wild roses and orange rowan berries. These will stay as long as the birds keep from eating them. On some years the bright winged birds, waxwings, will migrate from Scandinavia to feast on these berries, particularly the Rowans.

This time of year we will see more blackcaps and increasing groups of pied wagtails particularly, skittering across flat surfaces like roads, car parks and playgrounds. The flocks of starlings may not form the massive patterns or murmurations seen at Poole harbour or on the Somerset Levels but we can have some flocks of a few hundred weaving and rolling in the sky over the village.

The holly berries that this year seem in abundance will soon be eaten and unless they are picked will all be gone by Christmas. It is possible to pick the branches of berries early and push them into damp soil in a greenhouse to preserve them for Christmas, although this will deprive the birds.

Pip Bowell

WOODS FUNERAL SERVICES

Providing a caring service since 1878

Independent Funeral Directors

Memorial Specialist

24 Hour Personal Service

Prepaid Funeral Plans

Pauline J Guy Dip FD MBIFD

Allan Quartermaine Dip FD LMBIFD

Visit us at: 11A Icen Way, Dorchester, Dorset, DT1 1EW

Call us on: 01305 250425 Fax: 01305 250625

Email: enquiries@woodsfuneralservices.co.uk

Website: www.woodsfuneralservices.co.uk



Yoga sessions and getting ready for Christmas at Ladybirds

OUR helper Emily has started doing short yoga sessions at Ladybirds. The children love it and are getting good at demonstrating the poses, which include mountain, tree, aeroplane, dragon, cobra and warrior (or Ninja as one child calls it).

Following last month's topic of fireworks we carried on looking at the night sky and thought about light and dark. With torches shone and shadows made and lots of stories read. This moved on to space and the children enjoyed role play of being



astronauts entering rockets and going into space. One of our favourite stories *Whatever Next* by Jill Murphy became our book of the week and was read over and over again. With teddy in a box and a colander on his head we zoomed off for a picnic on the moon.

Our starry picture gained lots of planets on it and if you look very closely you may spot Father Christmas and his reindeer practising flying and getting ready for their big day.

Ladybirds have been busy also getting ready for Christmas making cards, decorations, and mini Christmas cakes which look delicious.

Happy New Year from all at Ladybirds

Liz Dyer

Milborne Ladybirds

Learning through play to help children achieve their potential

Opening times:

Monday & Tuesday 9.00 - 14.30

Wednesday, Thursday & Friday 9.00 - 13.00

Term time only.

Minimum attendance 3 hours per day
starting at 9am

With highly qualified and friendly staff, we offer a high quality preschool experience for children aged 2 years to school age in Milborne St Andrew and the surrounding area

Rated **GOOD** again by
Ofsted

"Children demonstrate an eagerness to learn, gain control and coordination in their physical skills and become confident communicators"

To find out more:

Call in to see us at the village hall or contact
Liz Dyer (Leader) on 01258 839117;
07771 512427; liz@milborneladybirds.com
Committee on secretary@milborneladybirds.com

Ofsted registered no.217717

www.milborneladybirds.com

Registered Charity no. 1087441

Chocolate Brownies

BROWNIES, originally called Rosebuds, were first organized by Lord Baden-Powell in 1914, to complete the range of age groups for girls in Scouting. They were first run as the youngest group in the Guide Association by Agnes Baden-Powell, Lord Baden-Powell's younger sister. In 1918 his wife, Lady Olave Baden-Powell, took over the responsibility for the Girl Guides and thus for Brownies.

Brownies were renamed by Lord Baden-Powell after the girls had complained that they didn't like being called Rosebuds. Their name comes from the story "The Brownies" by Juliana Horatian Ewing written in 1870. In the story two children, Tommy and Betty, learn that children can be helpful Brownies or lazy Boggarts.

Every month at our church in the 1950's there was a parade for all the uniformed youth organisations. Brownies and Guides, Cubs and Scouts all turned out in their uniforms, accompanied by their proud parents and after the church service they marched in procession from the Lychgate down the road to the Scout Hut. There was a tall and most handsome Scout leading the procession playing a big bass drum. The other lesser Scouts marching behind him were playing suitably martial music on smaller drums and bugles. They were followed by the Cubs, then the Girl Guides and with the Brownies bringing up the rear. We girls knew our place in those days. I can still feel the echoes of the bass drum as it seemed to resound in my tummy. I longed to have a go at banging the drum.

I also longed to join the Brownies as soon as I was seven years old. However, although dad was easy-going on most things, he disapproved strongly of uniformed youth organisations, saying that they smacked of Hitler-Jugend. WW2 still cast its long shadow over all our lives even over 10 years after its end. So both my brother and I were strictly forbidden to join Cubs or Brownies.

I felt this could be worked around, so asked a new friend from school, Anne, if I could try her Brownies pack which had meetings about a mile distant from our house. She then asked her Brown Owl, who was happy to have me come along to see if I liked it. I went out to play as usual after tea the next Monday and ran all the way to the distant hall, I felt it best to tell no one at home where I was going because I knew there would be trouble. As long as I arrived home before it was dark no one need know. We led free-range lives.

The smiling Brown Owl seemed kind and gentle and when she asked if my parents were happy to have me in Brownies, I kept my fingers crossed behind my back as I nodded 'yes'.

A dozen of us all sat in a circle and as Brown Owl called the register a strange girl next to me asked my name and then asked me in a whisper if I knew any

swear words. I thought this a strange request but ever happy to oblige I whispered back "Bug" which I'd often heard dad say in moments of crisis, or something rather similar. My new friend immediately put her hand in the air and said "The new girl just said a naughty swear word!" Brown Owl looked very annoyed indeed and lost her kind and gentle persona in an

instant. "You needn't bother coming again you naughty girl!" she snapped out and I felt ashamed and mortified. So that was the end of my career in the uniformed organisations.

Mum, of course, got to hear about it and she told dad so I was in no end of trouble at home. We may have been "free range" but everyone in our community looked out for everyone else and made it their business to report back to the parents any of their child's transgressions. My brother asked what swear word I'd said and when I told him he was very scathing. "That's not a proper swear word" he said and proceeded to instruct me into the art of very rude words. I could do a lot better than "Bug" by the end of my first lesson.

The next time I came across the treacherous tell-tale girl from Brownies I knew exactly what to say to her, "You dirty, nasty little Boggart" I hissed at her and I meant it to hurt.

I sometimes wonder if she remembers . . .

Three Little Angels

Three little angels, all dressed in white
Tried to get to heaven on the end of a kite
But the kite string was broken, down they all fell
They didn't get to heaven so they all went to ..'

?

Three little girl guides, all dressed in blue
Tried to get to heaven on the end of a shoe
But the shoe it was broken, down they all fell
They didn't get to heaven so they all went to ...

?

Three little devils, all dressed in red
Tried to get to heaven on the end of a bed
But the bed it was broken, down they all fell
They didn't get to heaven so they all went to ...

Don't be mistaken, don't be misled
They didn't get to heaven, so they all went to bed!

Brownies Recipe

Ingredients:

275g (10oz) butter, softened
375g (13oz) caster sugar
4 large eggs
75g (3oz) cocoa powder
100g (4oz) self-raising flour
100g (4oz) plain chocolate chips

Preheat the oven to 180°C/Fan 160°C/gas 4. Cut a rectangle of non-stick baking parchment to fit the base and sides of a 30cm x 23cm x 4cm traybake or roasting tin. Grease the tin and then line it with the paper, pushing it neatly into the corners.

Measure all the ingredients into a large bowl and mix with a hand-held electric mixer until evenly blended.

Spoon the mixture into the prepared tin, scraping the sides of the bowl with a plastic spatula to remove all of it. Spread the mixture gently to the corners of the tin and level the surface with the back of the spatula.

Bake for 40–45 minutes, until the brownies have a crusty top and a skewer inserted into the centre comes out clean. Cover loosely with foil for the last 10 minutes if the mixture is browning too much. Allow the brownies to cool in the tin and then cut into 24 squares. Store in an airtight tin.

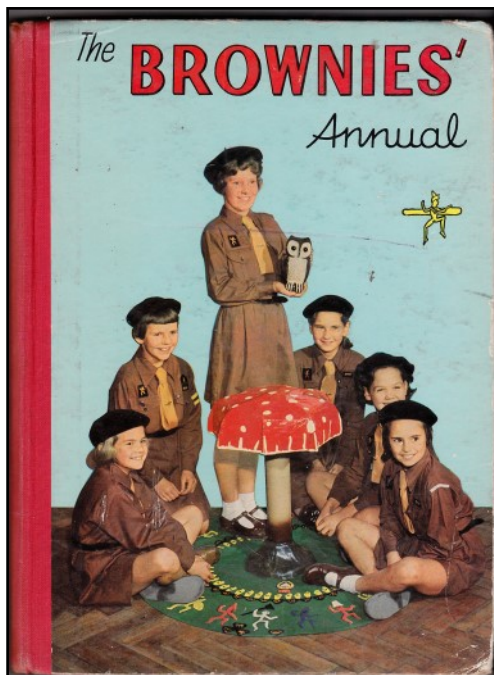

Barry Bright

Carpenter and General Builder

FREE ESTIMATES

Local builder for last 30 years

All building works undertaken

Extensions, All carpentry and roofing

Repairs, Maintenance

Hard landscape, Fencing, Brick Pavior Drives

Kitchens, Bathrooms

Double Glazing, Conservatories, Carports
and all plastic cladding

Also decoration work undertaken

Telephone: 01258 837042 Mobile: 07787551256

Greenacres, Dorchester Hill, Milborne St. Andrew

Blandford Forum, Dorset DT11 0JQ

GRASSBY FUNERAL SERVICE

*Still a family run business,
serving the local community since 1861*

Office and Chapel of Rest
8 PRINCES ST,
DORCHESTER

Tel. 01305 262338 (24 Hours)



MEMORIAL MASONRY
Memorial showroom at
9 Princes St, Dorchester

www.grassby-funeral.co.uk

Crazy panto at Lytchett Matravers!

AN "absolutely bonkers" panto, written and directed by a Milborne resident, is to be staged at the end of this month in Lytchett Matravers. Macbeth – The Pantomime is to be performed by Castle Players at Lytchett Matravers Village Hall and is the brainchild of Linsey O'Neill, who also wrote and directed the productions of Peter Pan and Cinderella. But, she says, Macbeth – The Pantomime is funnier and obviously a lot crazier! Think 'The Bard meets X-Factor' – the concept is inspired; completely insane, but inspired. They do say that there's a fine line between genius and insanity!

Duncan Blue is the King of Karaoke. But when Dave Macbeth bumps into some mysterious creatures who foretell his future, he and his wife Laydee will stop at nothing to win the Crown. Can young Marty Macduff and his mother stop them? Who will win Lytchett's Got The Strictly Voice Pop Star on Love Island Factor? Why is Spot the Dog there? Will Will be spinning in his grave? The stage is set for a full line-up of baddies, witches and ghosts, dames, lovers and hapless idiots. The story is full of laughs, groans and plenty of audience participation.

So, for something completely different, get your tickets for Macbeth – The Pantomime at Lytchett Matravers Village Hall on 24th, 25th and 31st of January and 1st February, including two matinees. Tickets are available on www.castleplayers.com or by calling 01202 912351 and are just £10 (£5 for under 12's) and *Reporter* readers can get a **10% discount** online, quote the code MSA10 when ordering.

Milborne St. Andrew Gardening Club

It's good to touch the green green grass of home . . .



The Gardening Club's new programme of events starts on 16th January 2020 in the village hall, starting at 7.30pm, when Linda Wright of Greensleeves, your local lawn treatment experts, will talk to us about all aspects of lawn maintenance. Linda will describe the many things that can go wrong with lawns, the common mistakes that people make when caring for their grass and what we can do to put things right. Linda knows her stuff, she never talks out of her grass . . . she'll answer your questions and get you chuckling as well. Do come along, you will be most welcome.

Everyone's a winner baby that's so true . . .

At our AGM in November, Linda Harris was presented with a cup to celebrate the fact that she was the overall winner of our 'Exhibit of the Month' competition. She'll be defending her title this year so it'll be 'gloves off' metaphorically speaking for the rest of us as we seek to challenge her supremacy. Want to enter the competition? You've got to be in it to win it . . .

For more information about the MSA gardening club contact Sally Dyer, 01258 837061.

Mark Johnson



Wellbeing support for Dorset farmers

ONE area of work that people don't normally associate with trading standards is animal health and welfare.

We have a small team of officers who are responsible for farm animal welfare and disease control. There is a lot of legislation aimed at licencing the movement of farmed animals with the aim of controlling some of the nasty 'exotic' diseases that threaten the farming industry such as foot and mouth, swine fever and avian influenza.

The team is also responsible for ensuring the welfare of the animals whilst on the farm, being transported, or being sold at market. These welfare standards are very simple – the animal should be fed a sufficient diet, have clean water to drink, somewhere dry to lie down and to be treated if they are ill.

The vast majority of farmers easily meet or exceed these standards, but occasionally we come across cases where the farmer is not doing enough. This can sometimes be down to financial difficulties, but more often than not it is because the farmer has mental health problems. Some farmers can become very socially isolated and with a busy farm to run they find it difficult to find the time to go to their doctors or talk with others.

There are some excellent organisations who can offer help and support to farmers who are struggling. One example is a charity called Farm Community Network (FCN). They have a team of volunteers in Dorset, many of who are farmers themselves, so they really do understand the problems faced in the farming industry.

If you or someone you know could benefit from talking with a sympathetic person who understands farmers and rural life then call the Farm Community Network on 03000 111999.

**citizens
advice**

Computer Problems?



**BLACKCAP
COMPUTING LTD**

**A friendly personal service..
Ring and have a chat.**

Telephone : 01258 881008

Mobile : 07979 853683

Email: steve@blackcap.net



Proud members of

Checkatrade.com
Where reputation matters

PURBECK AERIALS

SKY - SMART TV - WALL MOUNTED TV
FREESAT - EXTRA POINTS
RICHARD HARVEY
07976 222887 / 01929 553705
SAME DAY SERVICE
FREE QUOTES - OAP DISCOUNT
www.purbeckaerials.com

"I am local"

KMc Electrical Services

All types of electrical work undertaken for domestic, industrial and commercial properties

- Extra points to full rewiring
- Three phase
- Test & Inspection of building wiring
- Emergency callouts

No job too small

Professional, Quality service

Tel: 01258 881439

Mob: 07712 646131

Email: info@kmcelectrical.co.uk

ELECSA

REGISTERED MEMBER
ECA

TRUST
MARK
Government Endorsed Standard
www.trustmark.org.uk

Outward Hounds Pet Care & Walking Services

Companions for your friend. Peace of mind for their people.



- 🐾 Your local professional dog walker, 60 minute walks
- 🐾 Comfort and Companion visits for Dogs, Cats and Small Animals
- 🐾 Pet sitting, tailored Pet Care

Fully Insured - Pet First Aid - DBS - Member of PDWA

PHONE: 07900 207796

EMAIL: outwardhoundspetcare@gmail.com

FACEBOOK: Outward Hounds Pet Care & Walking Services, MSA.

Greenways Tree Care

and
Garden Services
(fully insured)



Felling
Reductions
Pruning
Stump Grinding
Hedges
Lawn Maintenance
Turfing
Strimming
Garden Fencing
Chippings delivered

Tim Moore

01258 837124

07968 154708

20 years experience
Free estimates and advice
Dewlish, Dorchester

GREAT NEWS
IF YOU ARE
LOOKING FOR
SOMETHING
EXCITING, FUN
AND CREATIVE
TO DO.

YOU WILL LOVE THIS ART COURSE

LEARN TO PAINT & DRAW PEOPLE & PLACES

Over the 14 week course you will explore four different media: **Drawing**, Painting with **Watercolour, Acrylics, & Oil Pastels**. Discover how to paint faces, figures, friends, family and stunning landscapes. Learn artists' secrets needed to create beautiful pieces of original art.

STEP BY STEP EASY LESSONS

- Fun part-time course
- 14 Week course, 3-hour classes, once a week
- Morning or afternoon sessions
- Beginners to improvers
- Fun, easy, social event
- We supply everything for you

WE MAKE IT EASY FOR YOU

Even if you have never picked up a brush before, we will guide you through to make it easy and fun!

On completing the course you will have 12 pieces of original art. This is an extremely enjoyable way to develop your creative side, and really enjoy the next few months.

STRICTLY LIMITED PLACES

To maintain a high standard of tuition, our classes are kept small, available places are strictly limited!



ABSOLUTE
BEGINNERS TO
IMPROVERS...
JUST LIKE YOU!

EASY, FUN,
NOW YOU CAN
GET REALLY
CREATIVE.



the
Seasons
Art Class

SA009219

MEET NEW
FRIENDS.
LEARN NEW
SKILLS



CURRENT
COURSE
FULL

AUTUMN
COURSE
STARTS SOON!

PLACES LIMITED.
PLEASE CALL NOW
FOR MORE DETAILS
AND A FRIENDLY CHAT.

01747 828 296
Weymouth Avenue Pavilion
Dorchester

Reducing my carbon footprint – part one, heating

KIDS are striking, grandparents are revolting (sorry, rebelling) and even Dorset Council has declared a climate emergency. Yet the government is moving at the speed of a melting glacier.

So I decided to see what I could do to reduce my carbon footprint. This series of articles will describe what I have learned; my success or lack of success, which I hope may be useful in showing some of the challenges ahead.

About a quarter of the UK's greenhouse emissions are from energy/fuel purchased directly by households – electricity, gas, petrol, diesel – so this seemed a good place to start. National figures show that in 2017 the average house in Milborne St. Andrew consumed about 13,000 kWh of gas (the national average was 18,000 kWh) which results in 2.4 tonnes of carbon dioxide (CO₂) being released to the atmosphere. Over 900 tonnes for the village, not including the houses using oil, storage heaters etc.

My 25-year-old gas boiler has been coaxed along since we bought the house and was finally removed to make way for our renovations. In 2018 we were finally ready to install a new boiler but it didn't make sense to put in another gas boiler. The alternatives were a wood pellet boiler or a heat pump. For various reasons I chose the latter. Heat pumps are an air conditioner in reverse. They quietly extract heat from the air, sending a cooling breeze across the garden. This heat is then transferred to the heating system and hot water. They have been around for many years and are a reliable technology.

A heat pump produces two and a half to three units of heat for each unit of electricity. The problem is that it can only heat water to around 45°C and is most efficient heating it to 30 to 35°C. This is great for underfloor heating but radiators will need to be larger. Also it can't heat a house up from cold in a short time. It is best at providing a gentle constant heat so that the house is always warm. This requires the house to be well-insulated.

Our house dates from the 18th and 19th centuries but during its renovation I have put in as much insulation as possible. The damp 1960s concrete floors were dug up and replaced with 150mm of insulation and underfloor heating. The loft has 300mm of sheep's wool insulation. The windows and doors are double and triple glazed. There are ways to insulate old cob (basically mud) walls and allow them to breathe but we did not go that far – 700mm of cob is not so bad. All the new walls have been built way beyond building regulations, even having insulating cavity ties - why put metal heat conductors through your insulation?

In the summer of 2018 we had two heat engineers come and design/quote for a system. We wanted the fan unit away from the house with better air flow and less noise. One of the engineers was much more knowledgeable and his design was much better for our requirements.

I had to make a few changes to the existing system, adding underfloor heating to the upstairs bathroom. There were lots of calculations about how much heat we needed and if the existing aluminum radiators were big enough. Finally we were ready and the system was installed over four days in November 2018.



The system pumps warm water around the house all the time (the upstairs radiators are off overnight) and the temperature of this water changes with the outside temperature. Touching the bathroom towel rail in the morning tells you how cold it is outside. It took a little while adjusting the temperature to get it right in all weathers but after that it just does its job.

The hot water is at 45°C – and warms up



to 60°C every Friday afternoon to kill off any bugs. My wife just has to remember to add more cold water to the bath that night.

And how much electricity have we used in the year – 3,500 kWh producing 8,700 kWh of heat. This produces about 0.9 tonnes of CO₂ so a saving of around 1.5 tonnes. As more renewable electricity comes on line, the carbon emissions will decrease.

Next month – the electric car.

Andy Mott

People's Choice Award: Surgery of the Year

ON Friday 29th November, at The General Practice Awards held in London, Milton Abbas Surgery was declared the winner of The People's Choice: Surgery of the Year.

For over 10 years the GP Awards have celebrated the very best examples of success from across primary and community care, recognising projects, individuals and teams who have gone above and beyond to improve healthcare provision in their area. The Awards are open to the whole of the UK, with entries received from England, Scotland and Wales.

This year the prestigious People's Choice award received almost 20,000 votes from patients, colleagues and members of the public. The volume of personal testimonials received for the award painted a touching picture about the impact that healthcare professionals can have on the lives of patients and their families.

Dr Martin Longley, Senior Partner at Milton Abbas who collected the award with four members of the team, said "Being presented with the award for People's Choice GP Surgery of the Year is undoubtedly the highlight of my career in primary care. It is testament to the unique environment at our surgery where everyone strives to provide outstanding patient care. Our goal is to know and understand our patient's needs and provide continuity of care throughout their time with us."

Castle Players at Lytchett Matravers present a
brand new, completely bonkers show -



Dave Macbeth is desperate to be crowned karaoke king, there's just one thing standing in his way, Duncan Blue, but Dave's wife, Laydee, knows just what needs to be done and she's not afraid to do it. The stage is set for a full line-up of baddies, witches and ghosts, dames, lovers and hapless idiots. The story is full of laughs, groans and plenty of audience participation.

Rehearsal have been a blast. There are times when we are rolling about with tears of laughter.

Performances are at Lytchett Matravers Village Hall on
24 Jan, (7.30pm) 25 Jan (2.30pm & 7.30pm)
31 Jan (7.30pm) & 1 Feb (2.30pm & 7.30pm)
and tickets are available on our website -
www.castleplayers.com or by calling 01202 912351
Tickets are just £10 (£5 for under 12's)
and Reporter readers can get a 10% discount online,
quote the code MSA10 when ordering

COLIN J. CLOSE FUNERAL SERVICE

*A family run business, serving the local
community of Blandford
and surrounding villages*



www.close-funeral.co.uk



Office and Chapel of Rest
Peel Close, BLANDFORD FORUM, DT11 7JU
email: info@close-funeral.co.uk

Golden Charter
Funeral Plans 

Tel.
01258 453133
(24 Hours)

Philip Trim
Contractors

ULTIMATE LIQUID & SLURRY SOLUTIONS

Septic Tanks / Liquid Waste Management

- * *Domestic & Business Septic Tanks*
- * *Liquid Waste Disposal*
- * *Local Professional Service*
- * *Event Hire*

RING NOW FOR DETAILS

01929 472192
07971 005579

Chamberlaynes Farm Workshop
Bere Regis Wareham BH20 7LS



National Association of
Agricultural Contractors



Environment
Agency Reg.
Wessex Water
Organic Waste

www.philiptrimcontractors.com
Email: info@philiptrimcontractors.com

Humour and compassion in dementia play at Village Hall

A PLAY set on a dementia ward does not sound like a barrel of laughs, but this tragi-comedy whodunnit, performed at Milborne's Village Hall, quite happily confounded any preconceptions. *Forget Me Not* bounced along with witty lines and black humour, interspersed with unexplained deaths amongst patients and staff. The well-painted characters were all skilfully played by Rob Gee, writer of the production, subtitled *The Alzheimer's Whodunnit*, on a minimalist set which comprised a single chair. Gee introduced us to Jim, husband to Elsie, who, he'd just been informed, had passed away on the hospital ward following a fall. Being a retired detective, Jim could not fail to notice a number of small details that nagged him into questioning whether her death really had been a tragic accident.

The ward has its fair share of 'challenging behaviour', and a day's work, a nurse describes, is "an endless rotation of feeding and toileting, with random acts of violence" thrown in. Andrito, a jaundiced Serbian who fought with the Chetniks as a teenager, is still fighting his demons, with staff bearing the brunt of his outbursts. Gee will have drawn from his past work as a psychiatric nurse on similar wards for inspiration and knowledge of nursing practices, although he is careful to state before we get underway that *Forget Me Not's* setting is from the 1990's and not an example of today's dementia care. Or shouldn't be.

After spending some time with his recently deceased wife, Jim becomes perturbed by what appears to be pressure marks on her arms, and skin with black hair attached under her nails. Added to this, her silver anniversary earrings are missing. Step forward another of the dozen plus characters that Gee effortlessly portrays, Janet Muston, the ward manager. The brusque and dismissive black-haired manager has a recent-looking scratch that may support Jim's theory of Elsie defending herself from someone. But it's not long after Jim's meeting with her to discuss his concerns that she is found lying in a pool of blood, on the wrong end of a paperweight wielded by Andrito. But then this explosive patient is found in his own pool of blood, and the mystery deepens.

Fingers are pointed at Jim by the detective sent to investigate; he has a motive, DI Rae says, since he blames the manager for Elsie's death and can he remember what he has or hasn't done, since Jim's own memory is failing? But the former detective has already conducted his own investigations, taking notes, with the staffroom lockers providing vital clues to solve what appears to be a triple murder case. For his opposite number, who speaks almost entirely in mixed metaphors, this could be a "spanner in the ointment" for his own theory.

Gee keeps it flowing with liberal sprinklings of dark humour that those who work at the sharp end of humanity will no doubt identify with. Since it's a time of crisis, Dean, the slightly gormless but likeable nurse, calls colleague, Timothy, to beg him to return to work despite his broken nose, courtesy of a punch from Andrito earlier. Dean says to him, "What with Janet being dead, we are short of staff". But it's the point-blank words of Jim that will resonate with many who have encountered this thief of a disease. He says, "Elsie's dead and it hasn't sunk in. I've already spent five years grieving – maybe I've run out of grief. I wish I didn't feel so relieved".

So whodunnit? Like the best murder mysteries, Gee keeps us guessing until the final reveal, with blind herrings and red alleys along the way, as DI Rae might have it. Bubbling away had been a feud between nurse Timothy and his manager, Janet, who bullied him, saying he wouldn't find another job other than on her ward. His attempt to frame Janet into overmedicating patients – and thus have her sacked – has backfired tragically with the death of Elsie. But there was no investigation, no inquiry, "cos when all's said and done, Elsie's just a dementia patient", so the put-upon nurse turns to extreme measures and kills his boss, trying to pin the blame on Andrito.

Forget Me Not is a window into people with dementia that feels timely – even though Rob Gee has toured with this production for a few years, the subject matter is ever-more relevant with the disease's numbers growing and the spotlight on how we treat those affected with it. What comes across from Gee's script is a call to compassion, to recognise people living with dementia are just that, people; receptive, emoting people; memory may be failing, but the ability to feel remains.

As Elsie pleads to future carers in a letter before her memory is mugged from her, telling them she will still feel things emotionally, "so smile a lot, have fun and lie to me. And when I finally lose it all, please give me somewhere soft to fall".

Ed Richards



Rob Gee's production was brought to the Village Hall by Artsreach, the charity that brings high quality arts events to rural locations. Milborne residents! If it is badged with Artsreach, it's definitely worth going to!

Something fishy happened on St. Andrew's day

THIS year, St. Andrew's church Events Committee planned their annual 'themed meal' to be held on St. Andrew's day, 30th November. As St. Andrew is the patron saint of fishermen and fishmongers, amongst other things, it was decided to theme the meal around 'fish'. The Royal Oak provided a fishy menu (as well as a vegetarian option). Some keen people decided to dress up; one was a pirate and three came as mermaids. Linda won the admiration of all with her blue hair and shell bikini top.

The function room was decorated with nets and Jenny's hand knitted fish. Even the tables were named after fish such as 'bloaters', 'crappie', 'pollock', etc. which made most people smile. Each diner had a handmade place setting sign, with a cross stitched fish, that they were invited to keep.

All were entertained by a fishy story, read with enthusiasm by Rose, and many joined in the singing of some sea shanties accompanied by the Fishermen's Friends CD. The raffle prizes also reflected the fish theme. The money raised from the evening will help to maintain St. Andrew's church. A great evening planned and organised by the Events Committee – thank you ladies.

Community Contacts

Please let the *Reporter* know if any of these details change

More information about many community organisations can be found on www.milbornestandrew.org.uk

COUNCILS

Dorset Councillor	Emma Parker	01258 881631
Parish Council – Dewlish	Clerk: Sandra Sims	01258 837132
	Chair: Andrew Booth	01258 837284
Parish Council –	Clerk: Wayne Lewin	07419 136735
Milborne St. Andrew	Chair: Richard Macnair	01258 837912

Floods A354 problems contact the Highways Agency 03001 235000
Dorset Direct 01305 221000
dorsetdirect@dorsetcc.gov.uk www.dorsetforyou.com/
reportroadproblems

Environment Agency Floodline	03459 881188
South West Highways hello@swhitd.co.uk	01404 821500
Wessex Water Sewerage Floodline	03458 505959
MSA Flood Warden, Non-Emergency Only: Mark Johnson	01258 839060

GENERAL – ADULT

Moonlight Swing Band	Gillian Pink	01305 260731
M.A. Neighbourcar	Nigel Hodder	01258 470333
Wednesday Social Club	Sheila Burton	01258 839033
Women's Institute	Lesley Clarke	01929 471732

GENERAL – YOUTH

Milborne Ladybirds	Liz Dyer	01258 839117
Scout Group	Sam Elliott	07873 762035
Under 5's Group – The Busy Bees	Claire Tudge	07970 734162
Youth Club age 8 – 13 years	Joanne Miller	07940 017577

POLICE

Police – Non-emergency contact	101
Community Beat Officer	PC Dave Mullins 101
Safer Neighbourhood Team	PC Dave Mullins and 101
	PCSO Luke Goddard 101
Home watch Co-ordinator	Richard Macnair 01258 837912

SCHOOL

Milborne First School		
Headteacher:	Sharon Hunt	01258 837362
Chair Governors:	Matt Way	
Friends of School co-Chair:	Marie Chappell and Natalie Dennis	

SPECIAL INTEREST

Bellringers	Pip Howell	01258 837329
Bridge Group	Laurie Benn	01258 837720
Cribbage	Peter Anthony	01258 837089
Dog Training Behaviour	Natasja Lewis	07896 275357
Food and Wine Society	Julie Johannsen	01258 839004
MSA Allotment Society Chair:	Joy Robinson	01258 837661
Secretary:	Anna Cullen	01258 837143
MSA Gardening Club	Sally Dyer	01258 837061
Milborne Players	Roy Sach	01258 837033
Round Robin Ramblers	Ian Bromilow	01258 880044
Tai Chi	Brian Burton	01258 839033
Village History Group	Pam Shults	01258 837203

SPORT

Abbey Swimming Club	Pat Cowan	01258 880601
Archers – Crossways	Sheila Ryall	01258 837504
Athletics – Information	David Pearson	01258 837057
Badminton	Bruce Dyer	01258 839117
Circuit training	Grace Martin	01305 213885
Cricket – Dewlish	Elaine Kellaway	01258 837696
Pilates (school)	Claire Barratt	07703 648869
Football – Veterans	Paul David	07841 506839

Football – Under 14s



Manager/coach	Andy Brown	07427 503373
Treasurer	Simon Buckingham	01258 839122
Skittles – Dewlish	Simon Ross	01258 837606
Sports & Social Club	Chairman: Richard Lock	01258 837929
	Bookings: Richard Lock	01258 837929
Tap Dancing for Adults	Kevin Selby	01305 250386
Tennis	Rich Hawker	07393 309037
Yoga (at school)	Sue Chapman	01305 848053
Yoga (at Sports & Social Club)	Saira Francis	01258 880505
Yoga (at Village Hall)	Sarah Ryan	01258 839230

VILLAGE HALL

Dewlish		
Chair:	Bernie Cosgrove	01258 837152
Booking Secretary:	Margaret Groves	01258 837617
Milborne St. Andrew		
Chairman:	Pam Shults	01258 837203
Booking Secretary:	Alison Riddle	01258 837148

HEALTH

Bere Regis Surgery	01929 471268
Milborne St. Andrew Surgery	01258 837383
Milton Abbas Surgery	01258 880210
Puddletown Surgery	01305 848333
NHS for non-emergencies	111
Patient Voice Secretary	Nigel Hodder 01258 880229





THE MILBORNE PLAYERS
WWW.MILBORNEPLAYERS.ORG.UK

PRESENT

WRITTEN BY LIMELIGHT SCRIPTS
as adapted by the Milborne Players

DIRECTED BY CAROLINE NOBBS



Dick Whittington

FEBRUARY 6TH, 7TH AND 8TH 2020
7.30PM WITH SAT MAT AT 2.30 PM

AT MILBORNE ST ANDREW VILLAGE HALL
TICKETS £7.00 BOX OFFICE 01258 839085
AND FROM M.ST.A LONDIS/GRAYS STORES

Community Events Diary

Add your event to this diary by contacting the **Reporter** – tel: 01258 837700 or email: msa.reporter@yahoo.co.uk

January

Wednesday 8th	Wednesday Club Party Village Hall 2.00pm – see page 3. New members very welcome.
Wednesday 8th	History Group The Royal Oak 7.30pm – see page 27.
Thursday 9th	WI Village Hall Darren Orchard will talk about 'Recycling' 7.30pm – see page 25.
Monday 13th	Village Lunch AGM The Royal Oak, 12.15pm. All welcome to attend
Tuesday 14th	The Reporter deadline. Copy and photographs by mid-day.
Wednesday 15th	Parish Council Meeting Village Hall 7.30pm – see page 27.
Thursday 16th	Gardening Club Linda Wright talk on Lawn Maintenance Village Hall 7.30pm – see page 21.
Friday 17th	Milborne Movies 'Isle of Dogs' the Village Hall 7.00 for 7.30pm tickets £3.50 at the door – see page 19.
Tuesday 21st	Ladybirds AGM The Royal Oak skittle alley 7.30pm – see page 19.
Saturday 25th	Village Lunch Village Hall, 12.15pm. All welcome to attend—see page 2 for menu.
Saturday 25th	Community Land Trust Public Meeting Village Hall 7.00pm — see page 27.
Saturday 25th	Nina Garcia playing at The Royal Oak from 9.00pm.

Donation recognition award

THIS photo was taken on the 28th November at a donor recognition ceremony at the Hermitage Hotel in Bournemouth. I was one of fifty people presented with a medal, a pin badge and certificate for donation of blood or blood products. Most of the recipients had given 100 units of whole blood but a few of us were presented for having donated a total of 250 units of platelets. I started giving blood in the early 1960s but more recently was asked if I would like to go on the platelet panel. The process is different from whole blood donation as it requires being connected to a machine that separates the platelets and returns the red cells back to the body. The process takes about an hour for each session and takes place at the blood transfusion donor unit above Boots in the Dolphin Centre in Poole.

The presenter of the awards was a lady who had suffered from Acute Myeloid Leukemia and had received a considerable amount of donated blood products and was expressing her personal gratitude.

Philip Bowell



Regular Bookings at the Village Hall

Ladybirds Playgroup Monday–Friday 8.30am–1.00pm MH (term time only)
Beavers Monday 5.00–6.30pm MH (term time only)
Players Monday 8.00–10.00pm MH
ABC Line Dancers Tuesday 7.30–10.00pm MH
Wednesday Club first Wednesday 2.00–4.00pm MH
Zumba Wednesday 6.00pm MH
Yoga Thursday 1.30–2.45pm MH
Gardening Club third Thursday 7.30–10.00pm MH
Karate Thursday 5.10–6.40pm MH
Village Hall Committee every fourth Wednesday 7.30pm
Women's Institute second Thursday 7.30–10.00pm
Youth Club 8–13 years every other Friday MH (term time only)
Village Lunch last Saturday of the month 12.15–2.30pm MH
Artsreach Events – look out for the posters.

Check Village Hall Notice Board for any other events that are one off for you to join in with.

Regular Bookings at the First School

Pilates Monday 7.00–8.00pm (term time only)
Yoga Tuesday 6.30–8.00pm (term time only)
Badminton Wednesday 6.30–8.30pm (term time only)
Circuit training Thursday 6.30–7.30pm (term time only)

Regular Bookings at the Sports & Social Club

Kickboxing Monday evenings 4.45–5.30pm Kanga (guide ages 5–8), 5.30–6.30pm Stripes (guide ages 9–13), 6.30–7.30pm ladies class, 7.30–8.30pm all ages and abilities. Contact Nikki Rich on 07752 199409.
Tai Chi Tuesday mornings 9.30am run by Geoffrey Bellinger. Local contact Brian Burton 839033.
The Busy Bees Under 5 Group from 9.30–11.30am on Thursday term time only. Contact Claire Tudge on 07970 734162.
Nightsabre Dog Training Behaviour and Rally Group. Tuesday mornings; Wednesday evenings; Saturday mornings. Contact details 01305 849221.
Yoga (Mellulah) Thursday (evening): Friday (mornings).
Boxing style fitness Friday 12noon–1.00pm. Contact Nikki Rich on 07752 199409.
Ballet style fitness Friday 1.00–2.00pm. Contact Nikki Rich on 07752 199409.
Beavers Friday 5.30–6.45pm
Private parties, birthdays, wedding receptions check online calendar.

Check the Sports & Social online calendar on the village website for any other events you might be able to join in with.



All copy for the **February Reporter** must be received by mid-day **14th January**. Please send copy via e-mail to msa.reporter@yahoo.co.uk.
 Send photographs as .jpg file, not .pdf file

Kens Kabs

Lady Driver & 6 Seaters Available
Airport & Cruise Terminal Specialists
Wheelchair Accessible Service





01258 456136
www.kenskabs.co.uk

TRAVEL SAFELY IN OUR HANDS

Silver Linings Pet Care and Training

Professional Service from a
Veterinary Nurse
Qualified Pro Dog Trainer
Fully Insured

Services Include:

-  Pet Care Visits in Your Home
 -  Group and One to One Dog Walks
 -  One to One Dog Training
 -  Wedding Day Care and Training
- and much more, see website for details*



www.silverlinings.pet
info@silverlinings.pet
07432 656 134

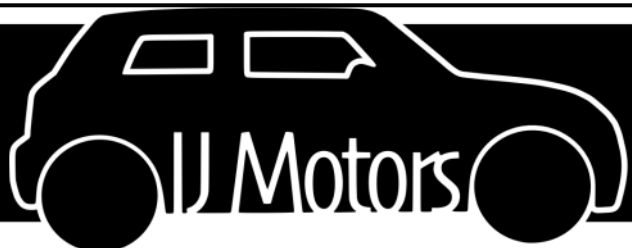

We are a local business
Established for over 40 years
Servicing, repairs and MOT work
All makes and models
Air conditioning specialists
Full diagnostic facilities
Free local collection and return

Contact: Ian Joyce
01258 881173 - 07789 724082
ianjoyce@hotmail.co.uk

PRICELESS PROPERTY MAINTENANCE

Do it right, do it once!



- *Painting
- *Decorating
- *Plastering
- *Rendering
- *K Rend
- *Tiling
- *Bathrooms
- *Kitchens
- *Gardening

Email:
pricelessplastering@yahoo.co.uk
Phone: 07943626082

Milborne Movies
Friday 17th January
at 7.30pm
Doors and Bar at 7.00pm

Milborne Movies
at the Village Hall
on the BIG screen

Supported by **Viridor** CREDITS

Isle of Dogs

Directed by Wes ANDERSON

Tickets £3.50

The Village Hall - Milborne St Andrew - DT11 0JX

Milborne Movies are showing Isle of Dogs At Milborne St Andrew Village Hall Friday 17th January.

Doors and bar open 7.00 for a 7.30 start

A film for all Wes Anderson lovers (his many offerings include The grand Budapest Hotel and Fantastic Mr Fox): in this stop-motion-animated film, an outbreak of canine flu in Japan (twenty years in the future) leads to all dogs being quarantined on an island. A boy journeys there to rescue his dog Spots, and gets help from a pack of misfit canines who have also been exiled. His quest inspires a group of dog lovers to expose a government conspiracy. The amazing voice cast includes Bryan Cranston, Edward Norton, Bill Murray, Scarlett Johansson, Tilda Swinton and Yoko Ono. One reviewer wrote: 'ISLE OF DOGS really charmed me. It's hilarious (wait 'til you see Tilda Swinton as a tiny bulldog aka Oracle), it's got heart and it touches on grave matters without ever preaching...' and another reviewer wrote: 'The ensemble cast wonderfully delivers Anderson's deadpan dialogue while leaving the beautiful animation and eye-catching visuals to guide the audience's imagination.'

All change on the Friends of Milborne St. Andrew First School committee

THIS year has been an incredibly busy year for the Friends of School (FoS) team. The fundraising over the last twelve months was so successful that FoS have been able to grant the School's wishes to pay for the supply and installation of brand new playground equipment which, at the time of writing, is scheduled to be installed in the next few months.

Income has been generated from many sources, including Christmas raffle ticket sales in 2018 through the Dorchester Rotary Club, the May Fair and Open Farm Sunday events. We have benefited from grants through The Milton Abbas Street Fair Trust and Hall & Woodhouse Community Chest. The Royal Oak held a charity bingo evening to support FoS and Gray's Stores continues to collect and donate the money received from the sale of plastic carrier bags to customers. We are again selling raffle tickets for this Christmas, which is being run this year by the Dorchester Casterbridge Rotary Club. We are extremely grateful for every single donation received and the support given to FoS by the village and wider community with our fundraising.

Many readers will be aware that Caroline Richards has very successfully headed up the FoS Committee for the past three years but now Caroline feels it is time to hand over the reins and take more of a support role. Caroline will be remaining on the Committee and no doubt her extensive knowledge and experience will be regularly called upon.

Looking ahead, the new Committee will be jointly led by Marie Chappell and Natalie Dennis as co-Chairs, Kate O'Kelly continues as Vice Chair, Leanne Brown has joined as Secretary and Bill Britton remains as Treasurer, along with eight ordinary members.

So, what's in store for 2020? Watch this space! The FoS team are working hard on some exciting new projects which will continue to benefit the School and children and, hopefully, be lots of fun for the village's inhabitants too.

FoS Committee



Milborne Ladybirds AGM 2020 - Have your say on how Ladybirds operates

PLEASE come along to the Ladybirds Annual General Meeting on Tuesday 21st January 2020 7.30pm in the skittle alley, The Royal Oak. The Committee really do need to know your views on how Ladybirds should operate now and into the future. We want to make sure that we provide the best possible service that remains viable and relevant to the village and local area. What are your views? Whether you're a parent, carer, family member or just someone that would like to help with the local preschool, please feel free to come along and have your say at the AGM. We look forward to seeing you.

For more information come along or contact
Kelly Haggett
secretary@milborneladybirds.com



www.hustingselectrical.com
 office@hustingselectrical.com
 Office: (01258) 837385 Workshop: 839052
 Mobile: 07973 574 215 or 07549 380 217
 New Services / Traditional Values
 Call or Email us with your requirements.

Hustings Electrical Ltd.

New Plumbing and Heating Division

All your plumbing and heating needs catered for, from new installations of gas, oil and electric flow boilers, servicing, repairs, safety certification / landlord checks to pumping solutions, showers, heat exchangers and underfloor heating. All repairs from leaks to dripping taps and replacement parts.



Tree & Hedge Services
 Covering Dorset

All aspects of Tree Work undertaken.
 Tree Felling, Reduction, Pruning.
 and Stump Grinding.
 Hedge Cutting and Garden Clearance.

All types of Garden Fencing.

Free no obligation quotes

Fully Qualified and Insured.

Call: 01305 542033 / 07760 157087

Email: info@nrptreeandhedgeservices.co.uk

Treat a member of your family.....



To book an appointment, call

Emma Whittington
 Staddlestones
 Milton Road
 Milborne St Andrew
 Dorset, DT11 0JZ

Tel: 07824 392813
 01258 839171

emmawhittington@btinternet.com

Follow us on



Line O' Type, Slugs and a Man for all Seasons and Inventions

I WONDER how many *Reporter* readers solved the editor's mystery picture puzzle 'Modern Art' on page 27 in the November issue? My bumbling attempt was a printing press; in fact it was a type composing machine that was, in its time, a revolutionary and sophisticated piece of machinery which changed the working lives of typesetters (like our editor, David Payne). Up to the end of the nineteenth century you set text letter by letter from a tray of type (or two trays, the second propped up behind the first with capital letters – hence 'upper case'). It was a slow, laborious process.

The *Linotype* machine was invented by Ottmar Mergenthaler in 1884 and was first used commercially in 1886 for the *New York Tribune*, a daily paper, and then for a large book titled *The Tribune Book of Open-Air Sports*. 25 years later, when the patent ran out, a very similar *Intertype* machine was introduced with several improvements, and by 1914 machines by Mergenthaler Linotype Company and the Intertype

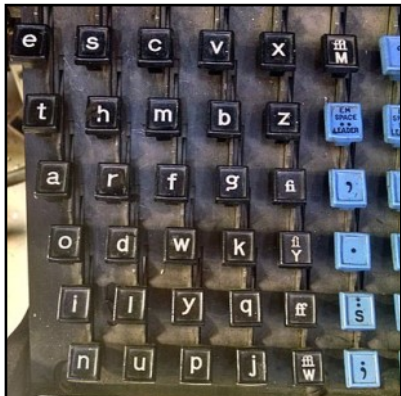

Company became used, especially by newspapers, throughout the world. Text was typed on a 90 character keyboard (very different layout from the familiar QWERTY typewriter, with lower case on the left, numerals and punctuation in the middle, and upper case on the right). *Matrices* or moulds for the image of each letter came down into a mould in

which a complete line of text, called a *slug*, was cast from molten type metal (lead/tin/antimony at about 330°C) before the next line was composed. These machines revolutionised typesetting especially for newspaper publishing, making it possible for a relatively small number of operators to set type for many pages on a daily basis. All major newspaper publishers used Linotype and similar 'hot metal' typesetting machines until the 1970's or 1980's when they were replaced by photosetting equipment, computerised typesetting and other page composition systems.



David working on an Intertype machine in 1995.

David, who began his apprenticeship in 1959 at the age of 15 with Dorchester Typesetting, was not introduced to an Intertype machine until the early 1970's. Before that he was a compositor/caster operator using the other popular typesetting machine introduced a little later in 1896 by the Monotype Machine Company in Pennsylvania. This machine had two quite separate parts. First there was a standard QWERTY keyboard which controlled pistons raised on compressed air to produce a perforated paper tape. Then, once the keyboard operator had finished his copy 'tapping', the paper tape was passed to a casting machine. Rather than producing a solid line of type, each letter was cast

separately which made corrections easier. The type was fed into a metal tray or *galley* from where it was clamped firmly in place in a metal frame (a *chase*) with any blocks of graphics or photographs, which fitted into the printing machine. A wide range of characters and fonts, intricate tabular work and other complex settings were all grist to the mill of this automatic, versatile machine.

So, by the time David retired in 2009, having lived in Milborne St. Andrew since his marriage to Barbara in Affpuddle Church in 1969, he had adjusted to several different forms of print production. His working and personal life mirror the enormous changes in society. Whilst living in Briantspuddle and attending Affpuddle School David experienced home life without electricity, mains water or an indoor toilet.

During his time at Dorchester Typesetting David worked on various magazines, including *The Lifeboat*, cookery books for M&S, programmes for Chelsea Flower Show, The Great Dorset Steam Fair and hundreds of books for Bloomsbury Publishing including the first two Harry Potter books.

It is amazing that during the last 50 years all this heavy machinery – and the associated printing presses – have been replaced by new technology. But the skills of the compositor are still there to be seen every month on each page of the *Reporter*. Carole Fornachon

A clarification:

On last month's *Letters to the Reporter* page the letter entitled 'Neighbourhood Plan – a Baton or a Stick?' should have credited the writer of it, Richard Lock. We apologise for this omission.

This Month

at the MILBORNE ST ANDREW
GARDENING CLUB



Linda Wright
Lawn Maintenance

THURSDAY
16th January



Refreshments



VENUE
The Village Hall
7.30pm

Open to All — everyone is welcome

Entry: £2 non members

Award winning lawyers that are by your side.

If you're looking for legal advice, we believe when it comes to choosing the right firm for your needs, reputation is important.

With an approach that makes the complicated simple, we work side by side with you to ensure you receive the best advice and results.

Blanchards Bailey is proud to be recognised by The Legal 500 as one of the top firms in the UK and named as finalists in every team category entered, including Law Firm of the Year, in the 2019 Dorset Legal Awards.



Blanchards Bailey
Solicitors

Telephone 01258 459361
www.blanchardsbailey.co.uk



Blandford | Dorchester | Shaftesbury | Weymouth

Cut and cut again – new grass mowing plan

IN a bid to 'make Milborne more beautiful', it is being proposed the village's verges and grassy areas will be cut an extra ten times a year. The cost for the extra grass cutting will be approximately £2,000 and will be paid via the Council Tax precept for the village, although the precept will not increase due to the PC's budget being juggled. Dorset Council is reducing the amount of maintenance it is doing – from twelve cuts down to three for Milborne's grassed areas – in a bid to save money, but also to improve conditions for wildlife. Roadside verges can provide a rich habitat for pollinators and other insects and changed methods, such as collecting debris after cutting, reduces soil fertility, reducing grass growth and thus increase the abundance of wildflowers.

The map shown indicates the areas of grass that are to be included in the Parish Council (PC) cutting plan. Richard Macnair, chair of the PC, says that the extra work is necessary since residents had complained last summer about "knee-high grass" after the county council had reduced cutting times. Mr Macnair also says that unkempt grass can attract litter and dog mess. There will be some areas on the plan that residents nearby may already be cutting on a regular basis, but the PC says that it will listen to people and remove areas from the cutting scheme if required. Hedges at some locations will also be cut, but Mr Macnair says they will work with wildlife and cut them at the most opportune times.

If you would like to get in touch with the Parish Council, please see page 16 for contact details.

Ed Richards

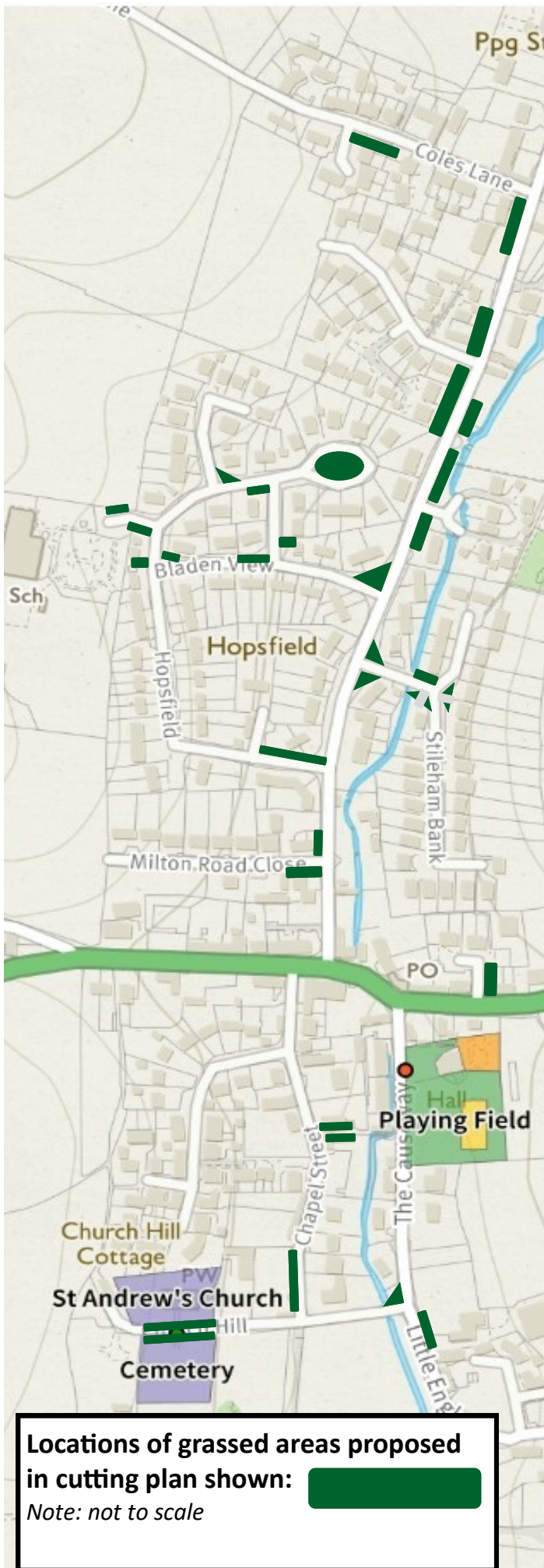



RHS CHELSEA SILVER GILT
www.queenthorne.co.uk

Purveyors of the Finest Gardens

01935 850848

**Extend your home and maximise
your outdoor space**

Consultation
Design
Construction
Ground Preparations
Water Features
Turfing & Seeding
Planting
Renovations
Wild Flower
Meadows
Lawn Care

As seen on the **BBC**



Our specially tailored treatment programme will ensure
your lawn is in excellent condition all year round

Weed Free ■ Lush Green ■ Moss Controlled



FREE Lawn Analysis & No Obligation Quote

Call us NOW on: 01258 839255

FREephone 0808 100 1413 • www.greensleeves-uk.com

A Darby Building Services Ltd



All Types of Building Work Undertaken;
New Builds, Extensions,
Structural Alterations, Kitchen,
Bathrooms

Telephone: 01258 470151

01305 757162

Mobile: 07974 260938

Email: adbsltd@gmail.com

Gerry's Plants

Shrubs, Perennials
Summer & Winter
Bedding & Baskets
Vegetable Plants in Season

Come and see them at:
12 The Rings, Milborne St Andrew
Telephone: 01258 837386

Yoga in Milborne

**Yoga class on Thursdays in term time
in the Village Hall, 1.30 – 2.45pm**

I also teach one to one in my home,
whether **your needs are for yoga as
therapy or meditation or a
simple way of keeping yourself healthy.**

For information ring

Sarah Ryan on 01258 839230

or email saryan6630@gmail.com

Yoga teacher, trainer, therapist

Gifted a gadget this Christmas? Free and friendly help is available

IF you have been gifted a computer or gadget over Christmas and don't know how to switch it on or make the most of it then help is at hand.

There are over 75 Digital Champions volunteering in Dorset libraries to help people with computers, tablets, phones and more. Most have gained experience from their professional careers.

Around 21% of people are not confident using the internet – that's around 150,000 people across Dorset. And 70,000 of these have never been online.

Not everybody has access or the desire to use computers but attending a session may spark an interest. Many learners have bought a tablet or similar, because of the programme.

Carol and Allan Lander in Swanage, Dorset, were helped by Simon Parvin, Digital Champion based in Swanage. They attended as a couple at the library.

Carol said: "Simon was very patient and helped me where I was having difficulty. He explained things fully. My friend recently bought a new smartphone, I told her to go and see Simon. We were both impressed with his patience. It was incredible. Before, I could get as far as putting the power plug in and now I no longer fear computers crashing in front of me.

Allan had some knowledge of computers. He wanted to know about PayPal specifically, an online payments system. It supports online money transfers and serves as an electronic alternative to cheques."

Digital Champion Simon said: "So much in life now depends on using computers, I am pleased to be able to help people to get going, and to solve their many and varied problems. It is a vital service and good to see people gain experience and confidence with their computing skills."

People without a device can learn free of charge on the library facilities. The sessions are held in a friendly environment and you go at your own pace.

Some Dorset residents say they feel excluded if they are offline and that learning with a Digital Champion boosts their confidence and helps them stay safe and independent.

Thanks to the Superfast Dorset team it is easy to find your nearest volunteer. Call Dorset's Digital Champion helpline on 01305 221048 and we'll answer any questions about the support available. All our help is free.

Round Robin Ramblers

The local villages walking group

WALKS are normally held on the first Sunday and the third Wednesday of each month. Please join us as we enjoy exercise, good company and the wonderful Dorset countryside. Any questions, please feel free to contact: Ian Bromilow on 01258-880044.

Wishing you all a very merry Christmas and a healthy and fit 2020!

Sunday 5th January – 1.30pm (*note earlier starting time during winter*)

Broad Oak and Sturminster Newton

Meet at Fiddleford Mill car park, off A357 from Sturminster Newton to Shillingstone. Grid reference: ST 802135 on OS Explorer Sheet 129 (approx. 4.5 miles)

Wednesday 15th January – 11.00am

Melbury Hill

Meet at the National Trust car park, Fontmell and Melbury Nature Reserve, on the higher Blandford Forum to Shaftesbury Road. Grid reference: ST 696132 on Explorer Sheet 129 (approx. 6.5 miles). Bring a packed lunch.

Sunday 2nd February – 1.30pm (*note earlier starting time during winter*)

Bonsley Common, Turnworth

Meet at Okeford Hill car park. Grid reference: ST 812093 on OS Explorer Sheet 117 (approx. 4.5 miles)

Please note:

Who All welcome including well-behaved dogs and their responsible owners. No pre-booking required just turn up.

Wear Suitable clothing for wet conditions and location, walking boots or Wellington boots.

Bring Waterproofs and refreshments (packed lunch on Wednesdays).

Pace We go at the pace of the slowest.

Terrain Expect mud, inclines and stiles.

Aim Keep fit, enjoy the Dorset countryside and each other's company.

Legal We look after one another but in the end you are responsible for yourself.

Village Hall news

WE have now replaced two swings which have been out of action for some time. All the correct bolts etc eventually arrived! The next piece of equipment to tackle will be the log walk. We are still trying to find a company to overhaul the zip wire as the company that installed it do not offer any such service.

In the kitchen both water urns are now working so cups of tea all round! And when you wash up the sink is mended too! Blinds are now installed on the doors. All these little jobs do show the need for someone to help with the maintenance – we are still looking so please consider giving a little time.

The hall was decorated for Christmas in time for the user groups meetings and the Christmas Fair; it looked very festive.

Finally, the committee wish everyone a very happy and peaceful New Year.
Linda Wright



Dinners all ready for their lunch at the Village Christmas Lunch

Christmas with the WI

THIS was a festive gathering – following our now traditional, and always enjoyable, party lines. Nelda had organised a collection for our chosen charity, Riding for the Disabled, which produced a donation of £90. As ever there was a delicious supper and the opportunity for a social get-together, with generous raffle prizes. We look forward to getting together again in the New Year. Please join us on Thursday 9th January, when Darren Orchard will talk about 'Recycling'. *Pat Bull*

JURASSIC

— COMPUTERS —



The incredibly friendly computer people

Call Darrell Hounscome or Lee Thompson for jargon free, patient, friendly computer help for home and business users.

Whatever your computer problem, call us... we can help!

01305 755668

Repairs • Servicing • Sales • Training • Virus Removal

Email: info@jurassic-computers.co.uk
Web: www.jurassic-computers.co.uk

Are you ready for a new PC or Laptop? If so, come and see us. We offer a complete service and will guide you through the whole process. We can supply, update, set-up and then transfer your documents/emails from your old system. We will give you the benefit of our combined 37 years experience gained whilst working for Kingston Maurward College in Dorchester.

PROSPECT HOUSE, PEVERELL AVE EAST, POUNDBURY, DORCHESTER DT1 3WE

Roka Relaxation

Holistic Therapies

Massage - Hot Stone Massage -
Ear Candling - Indian Head Massage -
Reiki - Baby Massage Instruction

www.Roka-Relaxation.com
Email: Balance@Roka-Relaxation.com
Telephone: 07834 060662 ~ Milborne St Andrew

A.J. LAKE

Painting & Decorating

Interiors & Exteriors
FREE quotes
25+ years experience
References available
No job too BIG or SMALL!
Tel: 01258 837 687
Mob: 07989 817 826

I want to share my diet secret with you... I have lost **over 3 STONE** in **3 months** and I have learned how to keep that weight off for good . . . If I can do that, then you most definitely can. I have experienced every problem and hurdle with dieting - so I honestly understand everything you are going through.

Over the years I piled on the weight. I don't know why ... I guess there are times in life when you feel a certain way and take advantage of the food that is front of you. I have tried just about every diet going and I never successfully lost and kept off the weight. Then I discovered the **Cambridge Weight Plan**.

I believe in this plan so much that I have recently qualified as a **Cambridge 1:1 Independent Consultant** – and will operate from home here in Milborne St. Andrew, with appointments available daytimes, evenings and Saturdays.

I will be with you **every** step of the way and won't abandon you once you reach your goal. There are various diet plans to suit everybody from total meal replacement to combination with real food. Plus, you will get a totally free and confidential appointment with me each week to keep you on track.

- Let's get you feeling fabulous; feeling happier;
- more confident. and of course, slimmer.
- Together we CAN achieve your goal.
- YOU are the priority, not a group.

THE 1:1 DIET

by **Cambridge Weight Plan**



Your local Independent Cambridge Weight Plan Consultant - Marie Hayter
Call me on 01258 837241 OR 07917 541857 for an informal chat or to arrange an appointment – **no obligation!**
No joining fee, no subscription fee, free consultations – you only pay for the products you purchase

What is the Village History Group?

EARLY in 2015 we invited Maria Gayton, from the Dorset History Centre, to give a talk about the history of Milborne St. Andrew. She was unable to find any significant information but told us how to research using the facilities at the centre. As several people were interested, we decided to form a Village History Group so that we could find out more about our village.

The purpose of the group is to provide support to those who want to explore our village's history either by finding out information or coming to meetings to hear what has been discovered. It was also agreed that we would invite occasional speakers to give talks about subjects relevant to our locality.

The group meet in The Royal Oak on the second Wednesday of the month, unless otherwise advertised. There is no specific membership so anyone is welcome to come along; all we ask is for a donation of £1 which helps to pay for speakers' fees. I usually email those people who have expressed an interest, to notify them of upcoming meetings. If you would like to be on my list please email me pamshults@btinternet.com

There was no history group meeting in December but we will resume at 7.30pm on the 8th of January 2020.

At our last meeting the group decided to try to find out more about the 'lost village/homestead' whose 'platforms' can be seen in the field whilst walking up the hill to Tolpuddle on the footpath which starts near the manor gates. So if you have any information, old maps, books, research, etc. do bring bits along.

Hopefully we can start to find out more about the site.

Season's greeting, see you in 2020.

Pam Shults

Tip of the month

AS the shortest day of the year is just behind us, and even though Christmas is said to be the season of goodwill, the opportunities for anyone with criminal intent can increase.

Shopping

- Take care at cashpoints, be aware of anyone waiting behind you and shield your PIN, only withdraw as much cash as you need and put it, and your purse/wallet away immediately.
- When carrying your bag, keep it closed with the clasp on the inside, if you don't have a bag, put purses, wallets, keys and phones inside your coat or in your front trouser pocket. Never leave your bag in or hanging from a shopping trolley.
- Park your vehicle in a secure car park, or a well-lit area.
- Keep vehicle doors and windows locked and don't leave valuables or presents on view.
- Avoid going back to leave shopping in your vehicle part way through your trip.
- Think about your pets, does your dog really want to go Christmas shopping with you, they may prefer to stay at home in the warm and it will leave you free to concentrate on what is going on around you.

At home

- Be careful to lock gates, doors and windows.
- Once you have unpacked, try not to leave the packaging on display; you are just advertising what you have in your home.
- While you are out and about, especially when drinking alcohol, enjoy yourself, but try to maintain personal awareness.

Prepare and plan ahead by pre-booking a taxi to get you home.

Wishing you a safe and happy time.

Elaine Ryan Prevention Development Officer

Have you something to share?

Send your stories and pictures to
msa.reporter@yahoo.co.uk

or give them to a member of the team.

Parish Council New Year Update 2020

"WHAT'S the point of the Parish Council?" is a question reasonably asked by council tax payers every year when they see the Parish Council Precept as an item on their council tax statements.

Milborne's Parish Council is currently made up of five independent volunteers from a wide range of backgrounds and experience from across the community who share a desire to do our best for Milborne. We are ably supported by our part time Clerk and Financial Officer, Wayne Lewin, who is also a local resident.

Parish Councils form the lowest tier of local government in England, and as such are funded via your council tax, but have very limited statutory duties (and still fewer powers!). With the exception of the responsibility to make provision for allotments, it is up to each community to define what it wants its council to "do", funded through your council tax. In Milborne, this has translated (over decades) into a low level of direct council expenditure: "We" own the land, purchased by the Parish via a nearly paid off loan, on which the Sports Club and Allotment Society operate as independent bodies and historically support the provision of other services via grants to local charitable bodies such as the village hall. In addition, we provide the formal route for the community to communicate with, and be consulted by, Dorset Council on such matters as planning (supported by our Neighbourhood Plan), services, flooding and highways.

Plans for 2020: Grass Cutting "Making Milborne More Beautiful"

Over the last couple of years many of you will have noticed the Precept creeping up. This was a result of councillors being warned by the old Dorset Council that they would be reducing the provision of grass cutting in public areas and that, should the community want this to be continued, we would need to fund it directly. From 2020 we will be doing this through a new single contract for grass cutting that is funded / supported by the Parish Council. This will replace four separate arrangements previously in place and provide the village with significantly better value for money, as well as a much better level of service, from within the same council budget. The Precept for 2020 – 21 will be set at Full Council at 7.30pm on 15th January at the Village Hall which will also see a presentation about a proposed Dorset National Park.

Community Land Trust Public Meeting: 25th January

At 7.00pm on the evening of January 25th the council will be facilitating a public meeting at the Village Hall to give interested villagers the opportunity to come together to start the process to set up an independent Community Land Trust [CLT] as a vehicle for the delivery of affordable homes for the local community. The session will be attended by representatives from the Wessex Community Assets team. They will be available, throughout the process, to provide support for the group, should sufficient volunteers come forward.

Community Activities Fund: Village Ramble

Later on in the Spring, Wayne, in his role as our volunteer Footpaths Officer, will be leading a village walk, the first initiative to take place under the banner of the new Communities Activities Fund proposed for the 2020 budget. Again, this new fund will be deliverable from within the existing Precept. We will let you know details in due course!

Cllr. Richard Macnair (Chairman)

Poppy collection in the village

THE Royal British Legion has let us know that the sum of £276 was collected from sales of poppies and wreaths in Milborne St. Andrew for Remembrance Day in November. Thank you to all who supported this very worthwhile charity and especially The Royal Oak, Gray's Stores, the Post Office and the school who all had collecting boxes on their premises.

Sally Dyer

Call us for a free no
obligation chat
Please quote 'AH2019' when calling



homeline
Your Mortgage & Protection Specialists

Amanda J X Hunt Adv CeMAP CeRER
Assistant and Paraplanner

Tim Rainey BSc Hons, Dip PFS, Cert SMP
Mortgage and Protection Consultant

- | | |
|--------------------|--------------------------|
| ✓ First Time Buyer | ✓ Credit Repair |
| ✓ Re-Mortgage | ✓ Interest Only |
| ✓ Buy to Let | ✓ Lifetime Mortgages |
| ✓ Further Advance | ✓ Bridging Finance |
| ✓ Commercial | ✓ Insurance Requirements |

We are your local friendly independent Mortgage and Protection Advisors; highly qualified with 20 years' experience in Financial Services. Using straight talking mortgage advice, we will pinpoint the most suitable Mortgage for you, saving you time, money and stress.

Amanda.hunt@homelinemortgages.co.uk | 07503 369001

Tim.rainey@homelinemortgages.co.uk | 07771 717989

Homeline House, 4 Beta Centre, 262 Ringwood Road, Poole, Dorset BH14 0RS
T: 01202 937444. E: info@homelinemortgages.co.uk

Your initial mortgage consultation is free. We charge a fee of up to 1% of the amount to be borrowed. Our typical fee is £295. Please see our website for further details. The Financial Conduct Authority does not regulate commercial loans and some forms of Buy-to-Let.
YOUR HOME MAY BE REPOSSESSED IF YOU DO NOT KEEP UP REPAYMENTS ON YOUR MORTGAGE.



Do you need transport for surgery and other medical appointments? If so, we can help.

Milton Abbas Neighbourcar is an established voluntary transport scheme covering the area served by Milton Abbas surgery. We can take you to medical appointments and certain social events.

WE ALSO NEED MORE DRIVERS – you can commit whatever time suits your circumstances.

Ring 01258 470333 to register or to obtain more information.

***Local villages covered:
Milborne, Cheselbourne and Dewlish***

In need of a Window Cleaner?

Darren

for a friendly and reliable service

Clear Vision

Fully insured for complete peace of mind

For that clearer vision just call:

01258 721975 / 07704 656777

or email: clearvision150377@gmail.com

Domestic and Commercial

Gutters Downpipes Facias Soffits

Conservatories Flash Roofs

ABBEY SWIMMING CLUB

We are a social club run entirely by volunteers, For less than £2 a week you can swim 3 times a week in a 25m pool. Any age welcome.

Fiendishly fit, hoping to be or you just enjoy a swim. Come along to a session for a FREE trial swim.



Tuesday 6.45pm - 8.30pm
Saturday 10am - Noon
Sunday 8am - 9am



We need Lifeguards

Become an RLSS qualified Lifeguard in return for club membership

We provide all training, includes First Aid and CPR Course suitable for anyone who is reasonably fit



For further information about membership or what is involved in becoming a Lifeguard come along to one of our sessions at the Pool, Milton Abbey School or contact us by telephone or email.

Call: 01258 881443 - Lynn or 881524 - Stephen or 880601 - Pat
Email: lynntargett47@gmail.com

Sports Club reaches for the sky

AN ambitious plan to literally raise the roof of the pavilion of the Sports Club has been put forward by the club's team. The scheme, which is at an early stage, would see the building at the Lane End sports field transformed with an upper floor built with a large balcony to take in the far-reaching views to the south.

Richard Lock, chair of the Sports Club, said, "We are nearing the limits of its current use and need to do something to move it forward. It is successful, but the pavilion was designed to accommodate two football teams, so we've got four team changing rooms and two for officials, toilets, a small kitchen and area for refreshments. Other than football, we've got a variety of users now, from yoga and personal fitness sessions to the parent and toddler group – we aim to be a comprehensive health and well-being hub for the community".

The pavilion is a popular venue for parties and wedding receptions and last summer played host to Quinfest, the music festival and the Four Churches Fete, which had lost its long-standing home of Athelhampton House. An upper floor with balcony would be an obvious boon in attracting new business to the club, including indoor sports and recreation, and Richard says the increase in capacity could have numerous uses, from active pursuits to other community purposes. He says that it will enable inside and outside activities to take place, with the possibility of an outside kitchen and barbecue on the balcony.

The design Mr Lock has put forward is one where the new upper storey would be supported by stilts around the outside of the present footprint, which would provide a larger covered veranda for the ground floor. But he points out that this particular design is to just get the ball rolling rather than the final plan. Richard is also keen to see the building be as environmentally positive as possible, with a roof of solar panels and heating gained from a ground source heat pump. Not only is it essential for the Sports Club to be a forward-looking, green venue, he says, but also it will help to minimise future running costs. He says, "We have already installed energy conservation measures, we're working on more and would like to see a new, green Sports Club building in the future". He's keen to see more talk in Milborne about what actions we can take as a community to oppose climate change and has offered free use of the pavilion for a community focus group of interested residents to hold meetings to discuss initiatives to this end.

It all sounds exciting but where would the money come

from to make the new, improved pavilion a reality? On the question of funding, Richard says, "I have never been a believer or a member of the "Oh it can't be done brigade", everything is possible and we could make a really good case to turn this dream into a reality. We could easily tap into the Government's New Strategy for an Active Nation and what is described as Sport England's bold and ambitious new investment strategy and capital grants schemes. They are seeking to invest in community sport at local level and has at its

heart the vision that everyone, no matter where they live, should be able to take part in a range of sport or physical activity. Milborne's Neighbourhood Plan also recognises that importance and there is, of course, Section 106 developer funding that could be made available. Where there is a will there must be a way". Of course, any plan would need to be agreed by the Parish Council which is the owner of the land at the Sports Club.

The next step though is to involve the community by getting together a project team to look into what the building should offer which would then inform the design and size of the new facility. Richard says, "We need some community-minded souls that can help to provide some focus on what people want. The feasibility study will involve brainstorming sessions, getting feedback from the community and ultimately drawing up the specification that will be used in the build tendering process. They won't be required to be involved with any of the Sports Club's day-to-day business, just guiding us to where we need to be in the future".

If you can help, please get in touch with Richard directly on 01258 837929 or email milbornesports@gmail.com

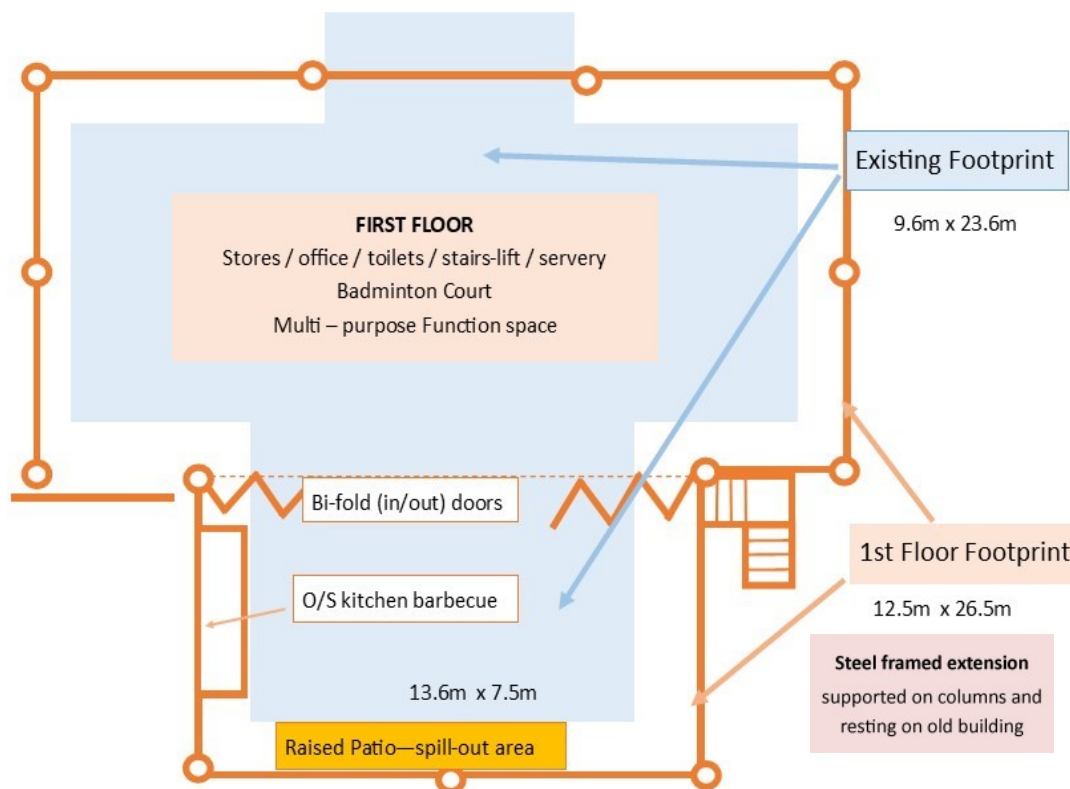
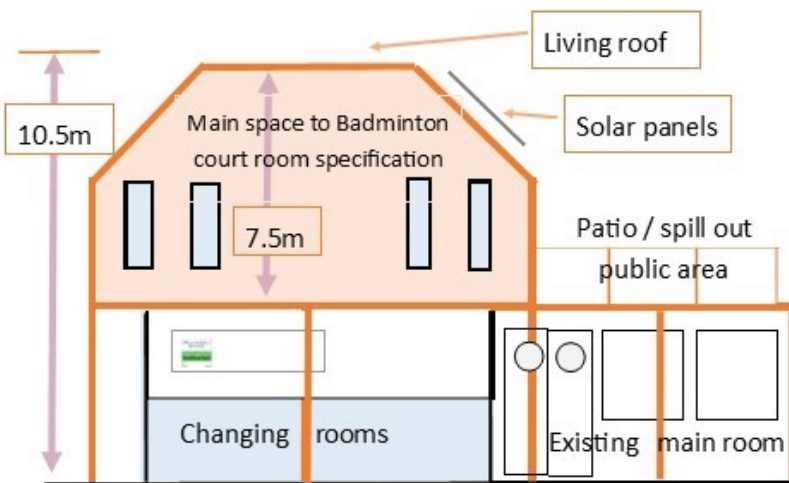



MILBORNE ST ANDREW FIRST SCHOOL

Learning together and having fun

SCHOOL NEWS



All our children were put through their paces and their multi skills were evaluated by Mr Dailey and his Year 8 Sports Leaders from St. Mary's Middle School, earlier in the term. The top scorers from Year 1 and Year 2 were invited to test their skills with other First Schools in the area. Everyone had a great time and enjoyed meeting the other children from the schools represented. Thank you to the parents for assisting with the transport to and from the event.

Seven of our Year 3 and Year 4 group represented Milborne at the DASP schools Netball Festival on Thursday 21st November. We came 3rd in the event, so it was a great effort from our budding netballers. Great job! Thank you to the parents for assisting with the transport to and from the event.

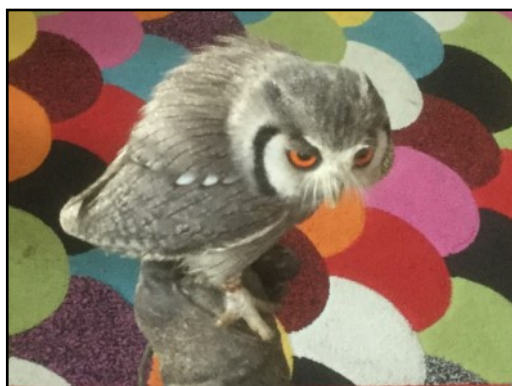

Dorset Falconry Park

This term our Year 1 and Year 2 group are reading the book 'The Owl Who Was Afraid of the dark' as part of their literacy and writing curriculum. To help the children get their creative juices flowing, we arranged a visit from some feathered friends. Martin from the Dorset Falconry Park, Lewell Mill Lane near Crossways, Dorchester (#xtremefalconry), brought in four owls to visit us on Thursday 20th November. The children and adults alike learnt lots of new words like diurnal and . . . as well as some very interesting facts about the owls and how they hunt. We would like to thank Martin for bringing in his owls, the children had a great time and are looking forward to seeing them again when they visit the park with their friends and families.

Dorset & Wiltshire Fire and Rescue, Bere Regis Team

On Thursday 28th November, we were lucky enough to have a planned educational visit from Gareth who was a firefighter and the Fire Engine from Bere Regis and some of her volunteer crew. Gareth taught us a 'wake and shake' dance about keeping safe. The children from Reception, Year 1 and Year 2 all had the opportunity to learn what to do in the event of a fire, as well as the opportunity to try out the fire hose to put out the 'cone fire' target. To finish the visit, the firefighters put the siren on . . . it was very loud!

Thank you to the team, the children had a great time exploring the different parts of the fire engine and listening to all the advice given.



CONTACTS

If you require any information about the school, including admission details, or would like to arrange a visit please contact the school office

Headteacher: Mrs Sharon Hunt

School Secretary: Mrs B Hosford

Chair of Governors: Matt Way

e-mail: office@milborne.dorset.sch.uk

website: www.milborne.dorset.sch.uk

Tel: (01258) 837362

Fax: (01258) 837170

Wednesday 4th December was Christmas lunch and party day at Milborne First School. As they have done for over 40 years, parents of children in the school planned, prepared and served a delicious Christmas lunch for all staff, pupils, Governors and friends of the school. The children really look forward to this throughout the year and it marks the start of the festive season for us all. After lunch, Father Christmas came to visit each class and the children had some fun playing traditional party games with their class.. Many thanks to all the adult elves who helped both on the day and behind the scenes. It truly was a very special occasion.



Milborne First School would like to give a big 'Thank You' to Lloyd Fraser for donating and Pete Jackson for delivering our beautiful Christmas tree again this year.





A family friendly traditional village pub in Milborne St. Andrew

What's on in January



Tuesday 7th
Closed from 5pm

Thursday 9th
International Curry Night
£10.95 per head



Thursday 30th
Pie Night
£10.95 per head

CARVERY EVERY FRIDAY & SUNDAY

12 noon to 2.30pm
£8.95 (Friday only)

From 6.00pm
£10.95

Smaller appetite
£8.95

Children
£5.95

All day Sunday
£10.95

Booking recommended

Dorchester Hill, Milborne St. Andrew, Dorset DT11 0JG
Visit www.theroyalokmilborne.co.uk
or for enquiries email hello@theroyalokmilborne.co.uk

TO BOOK CALL
01258 837248